

NOTICE

Note that when converting this document from its original format to a .pdf file, some minor font and format changes may occur causing slight variations from the original printed document. When viewing and printing this document, we cannot guarantee that your specific PC or printer will support all of the fonts or graphics. Therefore, when you view the document, fonts may be substituted and your individual printer may not have the capability to print the document correctly.

NEC

Electra **Elite**[®] IPK

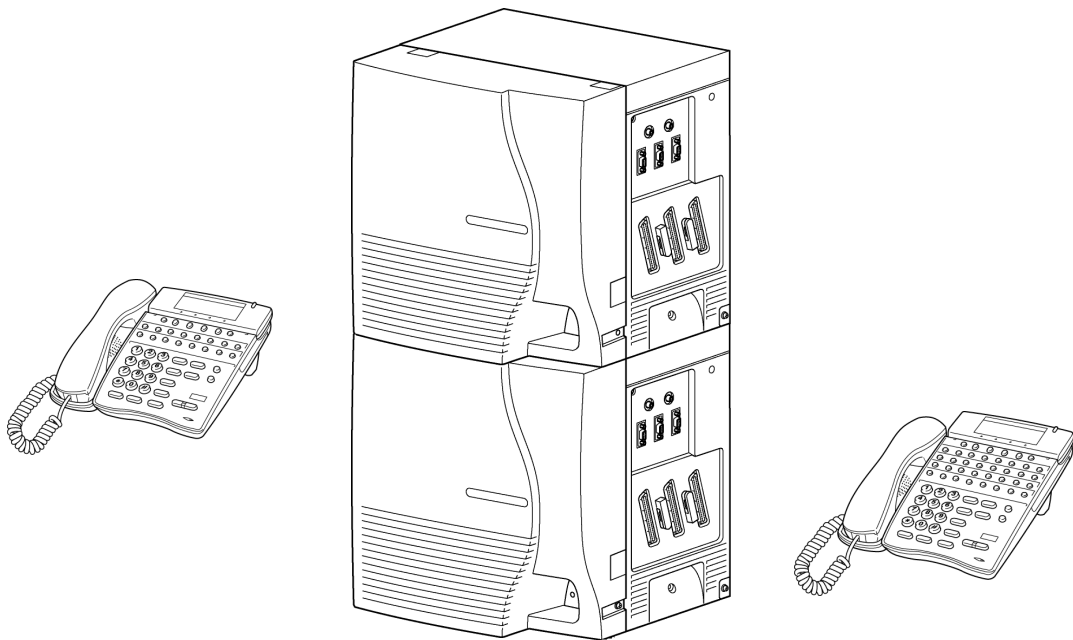

MEGACO STATION QUICK SETUP GUIDE

NEC America, Inc.

Document Revision 1

CD Stock Number 750454

Setting up the MEGACO Station Application

SECTION 1 HARDWARE SETUP

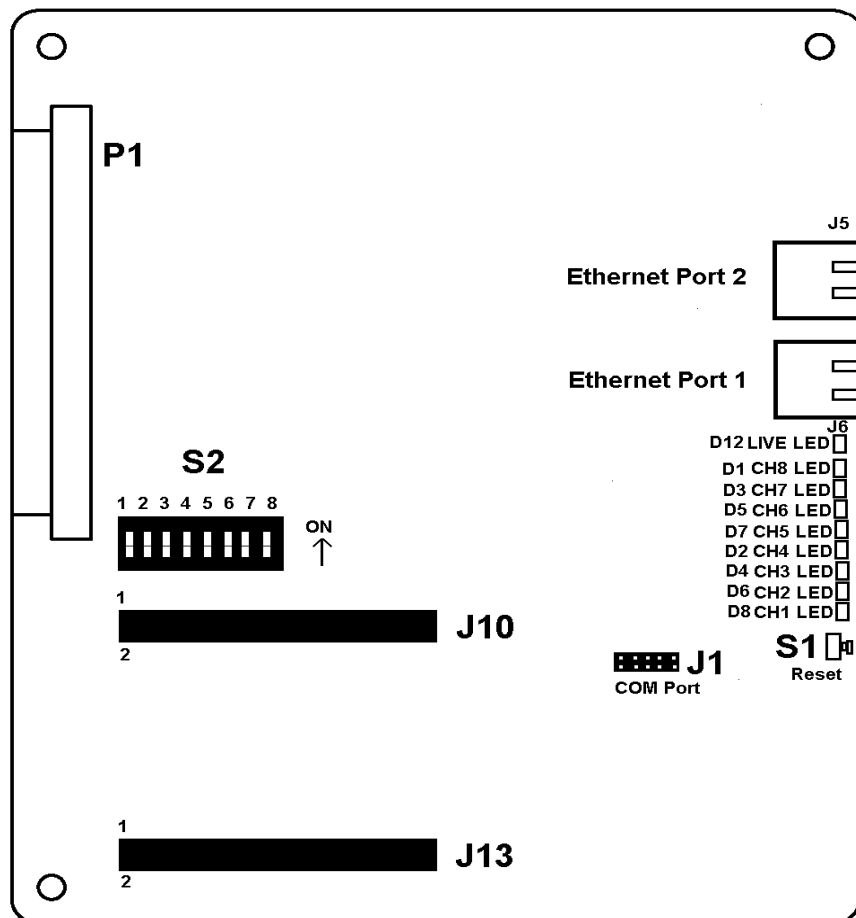

Figure 1 IAD(8)-U() ETU

1.1 Boot Up Sequence

The LED chart shows the status of the IAD(8)-U() ETU card during boot up. The LED conditions change as the IAD(8)-U() ETU passes through different boot states.

Table 1 Boot Up Sequence LED Patterns

STATE	D8 CH1	D6 CH2	D4 CH3	D2 CH4	D7 CH5	D5 CH6	D3 CH7	D1 CH8	D12 LIVE
1	○	○	○	○	○	○	○	○	✱
2	●	●	●	●	○	○	○	○	✱
3	○	○	○	○	○	○	○	○	✱
4	○	○	○	○	●	●	○	○	✱
5	○	○	○	○	○	○	●	●	✱
6	○	○	○	○	○	○	○	○	✱

● = LED ON
 ○ = LED OFF
 ✱ = LED Flashing

1.2 Connectors

- J6 = Default Ethernet connection

1.3 S2 DIP Switch Settings

Table 2 S2 DIPSW Settings

Reserved			Auto Sense	No. of Ports	Mode Operation			
SW1	SW2	SW3	SW4	SW5	SW6	SW7	SW8	
OFF	OFF	OFF	ON	ON	ON	OFF	OFF	ESI(8)-U10 ETU

1. Configure DIPSW S2 in accordance to Table 2. Place the IAD(8)-U() ETU in the Electra Elite KSU.
2. Connect the Ethernet cable to connector J6.
3. The CH1~CH8 LEDs start to run indicating that the system is initializing the IP Networking parameters. The Status LED (D12) is red (refer to Table 1 Boot Up Sequence LED Patterns).

4. Once all the LEDs are **OFF** and the Status LED (D12) is flashing red, the IAD(8)-U() can be set up with the system.

SECTION 2 ELECTRA ELITE IPK PROGRAMMING

After the Dip Switches have been set and the IAD ETU has been installed in the Electra Elite IPK KSU, you are ready to program the settings the for the IAD ETU.

The IAD (8)-U() ETU (MEGACO Station) is recognized by the Electra Elite IPK system as a ESI(8)-U10 ETU. This ETU takes a longer time to initialize than the other Electra Elite IPK ETUs and must be programmed using Memory Block 7-1 (Card Interface Slot Assignment).

2.1 Programming the ETU Interface Slot

The following procedure provides the general directions for Electra Elite programming for the ETU Interface Slot Assignment.

1. From port 01 or 02, enter programming mode.
2. Press **Feature** **Hold** **#** **0** **#** .
3. Assign the Card Interface Slot Assignment by pressing LK7 and LK1.
4. Press **1** , **2** or **3** for the cabinet number of KSU where the IAD (8)-U() ETU is installed.
5. Press **#** to move the cursor to the right.
6. Enter slot number (1~8) of the KSU containing the IAD (8)-U() ETU.
7. Press **Recall** to change the page number (Page 2) and assign the ESI ETU. Press **LK1**.
8. Press **Transfer** to write the data.
9. Additional programming is required to assign telephone type and station number.
10. Assign the telephone type assignment by pressing **LK7** and **LK2**.
 If assigning MEGACO terminals, assign ports as TEL=LK2.
11. Assign station number assignment on a per port basis (MB 4-10).



SECTION 3 IAD (8)-U() ETU WEB PROGRAMMING

When installed for the first time, the IAD (8)-U() ETU, comes up with factory set default parameters as shown in [Table 3 Factory Network Settings](#).

Table 3 Factory Network Settings

Host Name	neciad
IP Address	192.168.1.100
Subnet Mask	255.255.255.0
Default Gateway	192.168.1.1

In this configuration, the ETU cannot run in any randomly given environment, and its parameters must be redefined before the IAD (8)-U() ETU can work in your environment.

1. Boot up a PC with IP Address: 192.168.1.X, Subnet Mask: 255.255.255.0. Connect to the IAD(8)-U() either via a crossover cable or a small hub.
2. Connect to the IAD (8)-U() ETU via your Web Browser to the following link:
<http://192.168.1.100/>
 -  The IAD (8)-U() ETU supports Microsoft Internet Explorer 5.0 and higher.
3. When the login screen appears, enter the Login ID and password. Click **login**.
 -  Default login ID = **admin**
 -  Default password = **password**
4. Set the IP Address, Subnet Mask, Host Name, and Default IP parameters in the IAD (8)-U() ETU Card tab and select **Submit**.
5. Set the IP Station Encoding Preference, Packet Size, Jitter Depth and the IP Address (or use DHCP if using a DHCP Server) under the Port Tab and select **Submit**.

6. Select the **System** tab, then select **Reset the Card**. The ETU goes through a reboot cycle. This may take a few minutes.
7. Disconnect the crossover cable and connect the IAD (8)-U() ETU (MEGACO Station) to your network.

The ETU is now ready for operation.

THIS PAGE INTENTIONALLY LEFT BLANK